

**SPRAY GUN CLEANING KIT**  
**VECTOR PART NO. 300V817-1**

CONSISTING OF:  
 1 BRUSH  
 1 WRENCH  
 1 T-HANDLE WRENCH W/NEEDLE

114V198 - MODEL 012 (1.2mm I.D.)  
 114V199 - MODEL 015 (1.5mm I.D.)  
 114V200 - MODEL 020 (2.0mm I.D.)

114V226 - MODEL 015 (3.1mm ORIFICE)  
 114V227 - MODEL 020 (3.4mm ORIFICE)  
 114V228 - MODEL 025 (4.0mm ORIFICE)

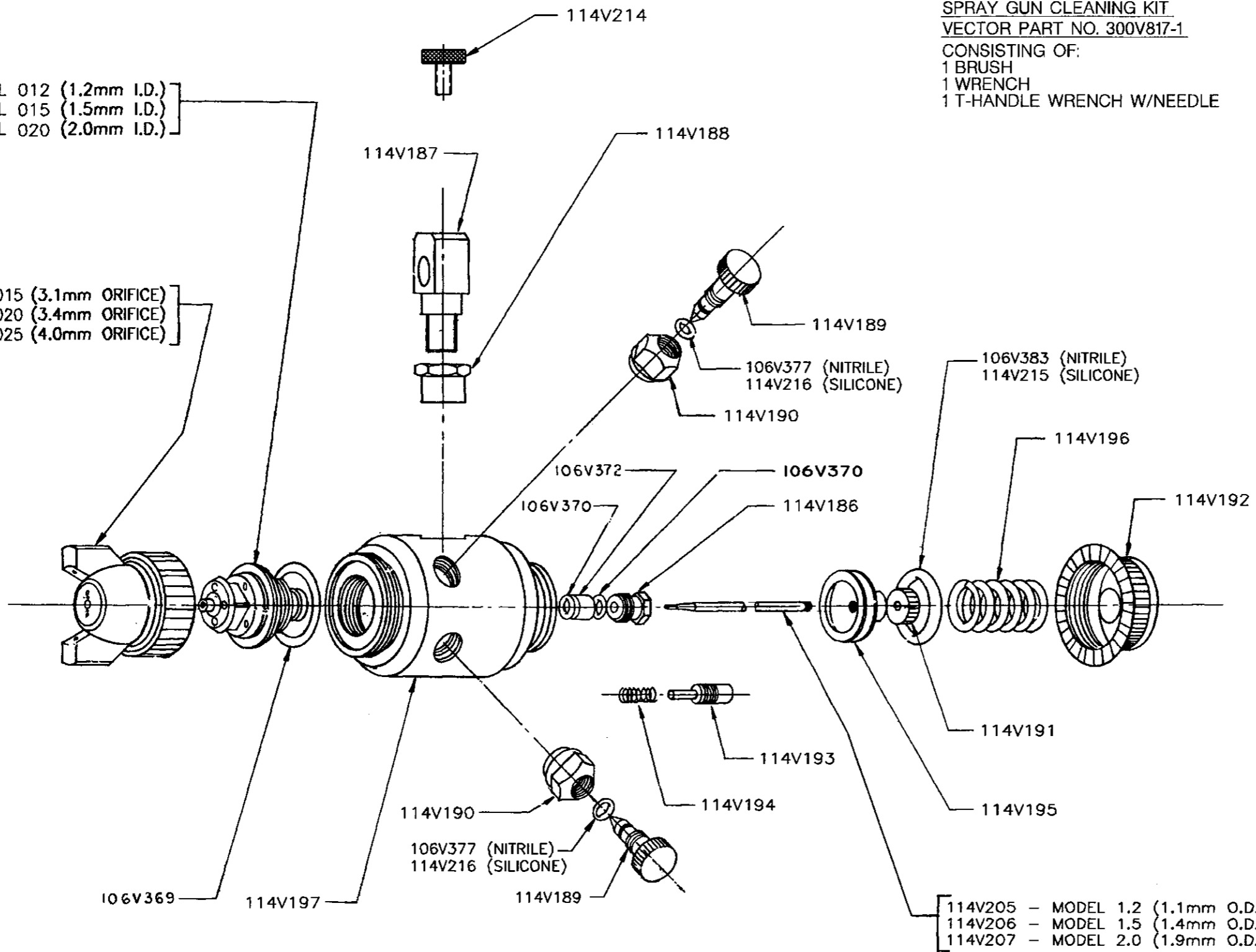

REF: HCA-9693 COMPLETE GUN WITH 012 NOZZLE AND 025 AIR CAP (316L SS)

SIMILAR TO 303V330

TOLERANCE UNLESS OTHERWISE SPECIFIED				DRAWN BY	G.MOEN	<b>VECTOR CORPORATION</b> 675 - 44TH STREET/PH. 319/377-8263 MARION, IOWA 52302
SHEET METAL/WELDMENTS				DATE	25JAN05	
FRACTIONS ±1/16 ANGLES ±1°				CHK'D BY	J.F.	<b>SPRAY GUN ASSEMBLY - SPL</b> TYPE .AT-316L (VERSION III AIRCAP)
MACHINED PARTS				DATE	26JAN05	
FRACTIONS ±1/32 ANGLES ±1/2°				MATERIAL	NOTED	DRAWING NUMBER <b>303V345</b>
DECIMALS .XX ± .01 .XXX ± .005				HEAT TRT	CALC <input type="checkbox"/>	
XXX ± .005				SCALE	NONE	
ALL MACHINED SURFACES 125 MICRO-INCH DIAMETERS  WITHIN .002 TIR						
ALL MACHINED SURFACES  WITHIN .002 PER INCH OF LENGTH						
ALL RADI SHOWN AND NOT SPECIFIED 1/16						
BREAK ALL SHARP CORNERS 1/32 X 45°						
▲ IDENTIFIES ADDITIONAL CRITICAL CHARACTERISTIC OR DIMENSIONS						
REV	ECO	ECO DATE	INT			
CLASS A	25JAN05	GTM				